

PCB terminal, Screw connection, No. of poles: 22, Width: 112.5 mm, Colour: Green

### Business data

|  |                   |
|--|-------------------|
| Article number                             | 5022.1            |
| Article name                               | PK 2,5/22/5,00 GN |
| GTIN (EAN)                                 | 4044211065621     |
| Packaging unit                             | 10                |
| Quantity unit                              | PC                |
| Packaging type                             | Carton            |
| Type of banding                            | Without           |
| Weight per piece (not including packaging) | 41.8 g            |
| Weight per piece (including packaging)     | 45.2 g            |
| Unit of weight                             | G                 |
| Customs number                             | 85369010          |
| Country of origin                          | CZ                |
| Prio-Article                               | 5022.1            |

### Technical data

#### Dimensions

|                     |          |
|---------------------|----------|
| Length              | 12 mm    |
| Length of the pin   | 4.5 mm   |
| Width               | 112.5 mm |
| Width left          | 2.5 mm   |
| Width right         | 5 mm     |
| Height              | 20 mm    |
| Drill hole diameter | 1.3 mm   |
| Pitch               | 5 mm     |

#### Ratings

|                       |                     |
|-----------------------|---------------------|
| Rated voltage         | 250 V               |
| Rated current         | 16 A                |
| Rated cross-section   | 2.5 mm <sup>2</sup> |
| Rated impulse voltage | 4 kV                |
| Overvoltage category  | III                 |
| Contamination degree  | 3                   |

#### Connection data

|  |                      |
|--|----------------------|
| Connection principle                                     | Screw connection     |
| Connection type of PCB                                   | Solder connection    |
| Type of attachment to circuit board                      | Connecting contact   |
| Angle of PCB/wire connection                             | 0°/180° (horizontal) |
| No. of poles   | 22                   |
| Number of levels   | 1                    |
| Wire cross-section single-core (rigid) / stranded, min.  | 0.2 mm <sup>2</sup>  |
| Wire cross-section single core (rigid)/stranded, max.    | 4 mm <sup>2</sup>    |
| Wire cross-section stranded, min.                        | 0.2 mm <sup>2</sup>  |
| Wire cross-section stranded, max.                        | 2.5 mm <sup>2</sup>  |
| Wire cross-section stranded with wire-end ferrules, min. | 0.2 mm <sup>2</sup>  |
| Wire cross-section stranded with wire-end ferrules, max. | 2.5 mm <sup>2</sup>  |
| Wire cross-section AWG, min.                             | 24                   |
| Wire cross-section AWG, max.                             | 14                   |
| Stripping length   | 7 mm                 |
| Screw threading  | M 2,5                |
| Torque   | 0.6 Nm               |

### Technical data

#### Materials

|                           |               |
|---------------------------|---------------|
| Insulation housing        | Polyamide 6.6 |
| Flammability class UL 94  | V-2           |
| Working temperature, min. | -30 °C        |
| Working temperature, max. | 105 °C        |
| Clamping element          | Steel         |
| Screws                    | Steel         |
| Soldering lug             | Copper        |

#### Further technical data

|   |                             |
|---|-----------------------------|
| Storage temperature, min.                 | -40 °C                      |
| Storage temperature, max.                 | 105 °C                      |
| Insulation resistance                     | 1*10 <sup>12</sup> Ohm x cm |
| Creepage-current resistance               | CTI 600                     |
| Glow wire flammability index GWFI         | GWFI 960                    |
| GWFI after-glow time                      | 30 Sek.                     |
| Glow wire ignition temperature GWIT       | GWIT 775 °C                 |
| GWIT exposure time                        | 5 Sek.                      |
| Recommended wave soldering temperature    | 260 °C                      |
| Recommended wave soldering duration, min. | 3 Sek.                      |
| Recommended wave soldering duration, max. | 4 Sek.                      |

#### Environmental Product Compliance

|                                |                        |
|--------------------------------|------------------------|
| REACH Conform                  | yes                    |
| REACH Reference date           | 2023-06-14, 2024-01-23 |
| REACH Candidate Substance Note | No                     |
| RoHS Conform                   | yes                    |

---

### Approvals

---

#### CSA approval

|                                  |                 |
|----------------------------------|-----------------|
| CSA approval                     | CSA 22.2 No.158 |
| CSA approval granted             | yes             |
| CSA Usegroup B: rated voltage    | 300 V           |
| CSA Usegroup B: rated current    | 20 A            |
| CSA wire cross-section AWG, min. | 24              |
| CSA wire cross-section AWG, max. | 14              |
| CSA stripping length             | 7 mm            |
| CSA torque                       | 0.6 Nm          |

### Media

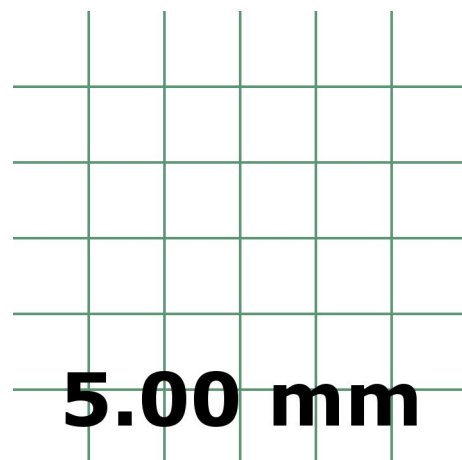
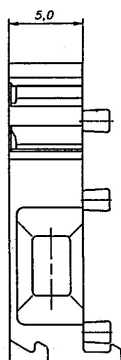
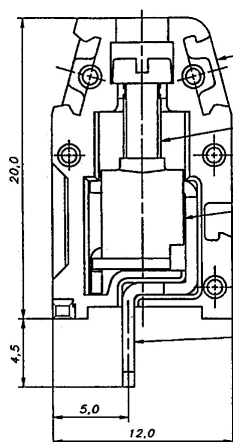

# M2.5

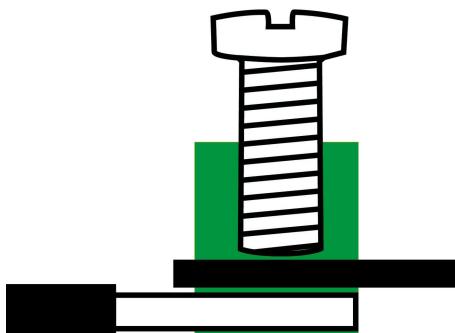

---

### Accessories

---